



**ST. HELIER**

**3 BEDROOM HOUSE - SEMI-DETACHED**

**ASKING PRICE £599,950**

*Where personal service flies high*



## DESCRIPTION

Spacious 2-Bedroom Semi-Detached Home with Separate 1-Bedroom Unit.

This spacious property offers a rare opportunity to secure a modernised semi-detached family home located on a quiet residential road in St Helier; perfect for two-generation living or generating additional rental income. The main residence is set over two floors and features a bright and welcoming living/dining room, a fully fitted kitchen and two bedrooms upstairs. Glass doors open onto a large, private rear garden that enjoys all-day sun.

The self-contained one-bedroom unit is arranged across a single level and includes a separate kitchen, reception room, double bedroom, and bathroom. With its well-proportioned layout, it offers excellent flexibility for extended family, guests, or a excellent rental income opportunity. Situated in a quiet residential area, the home is just a short stroll from all the amenities of town including schools, shops, restaurants, bars, and public gardens; while still offering a peaceful, community-oriented setting. You'll also benefit from easy access to excellent transport bus links, making daily life convenient and well-connected. Immaculately presented and ready to move into, this home offers versatile living with scope to suit a wide range of needs. Whether you're a growing family, investor, or simply seeking flexible space in a central location, this is a rare find in one of Jersey's most popular parishes. Early viewings are highly recommended.

## DETAILS

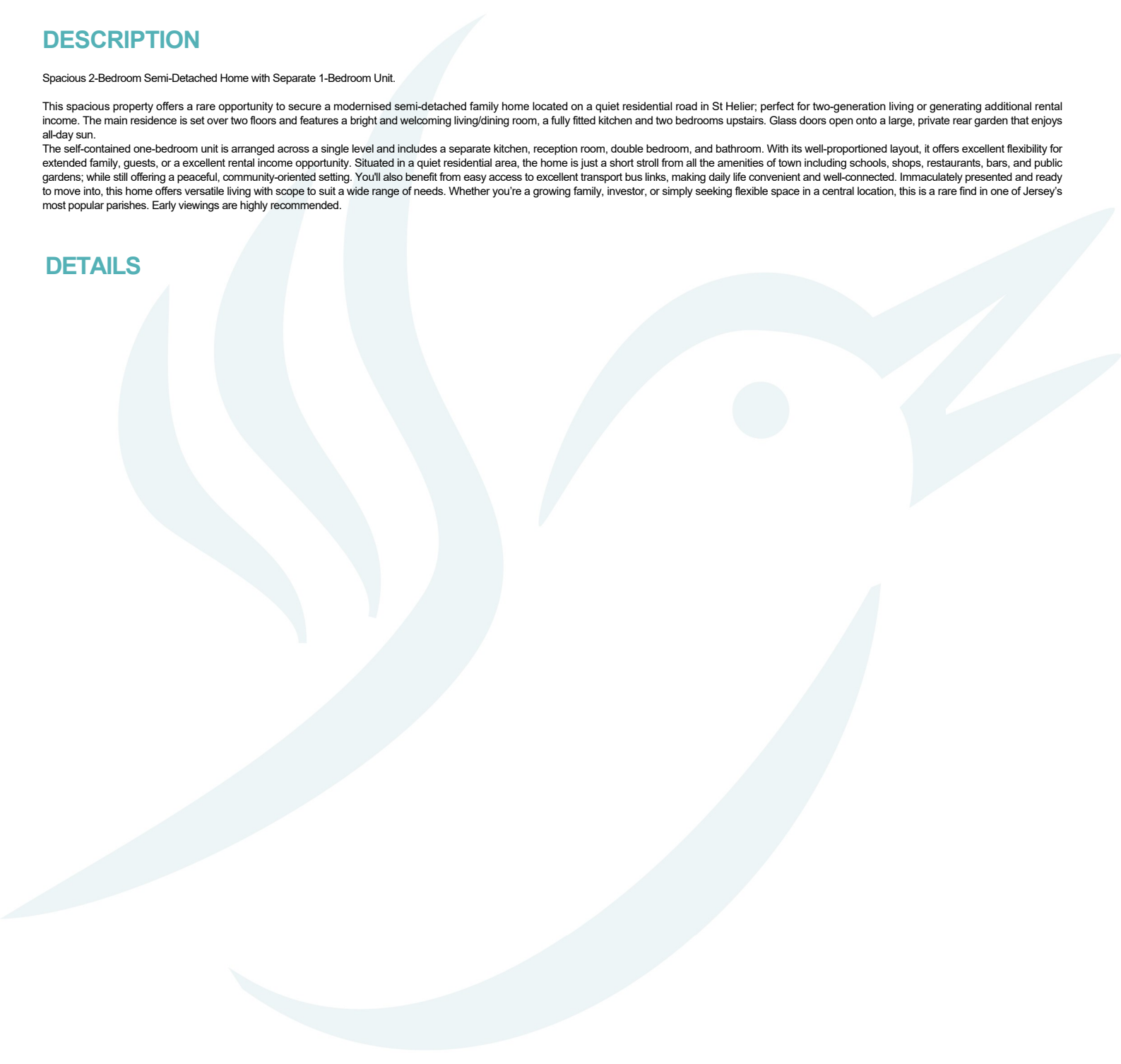





Approx Gross Internal Area  
98 sq m / 1054 sq ft

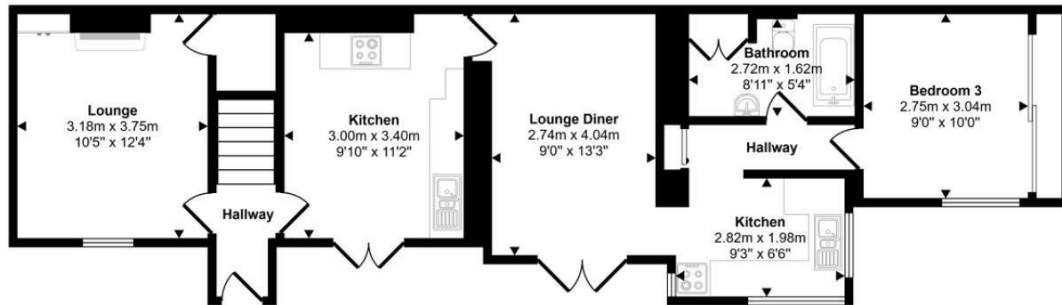

Ground Floor  
Approx 68 sq m / 728 sq ft



First Floor  
Approx 30 sq m / 326 sq ft

Whilst every attempt has been made to ensure the accuracy of the floor plan contained here, measurements of doors, windows, rooms and any other items are approximate and no responsibility is taken for any error, omission, or mis-statement. The measurements should not be relied upon for valuation, transaction and/or funding purposes. This plan is for illustrative purposes only and should be used as such by any prospective purchaser or tenant.

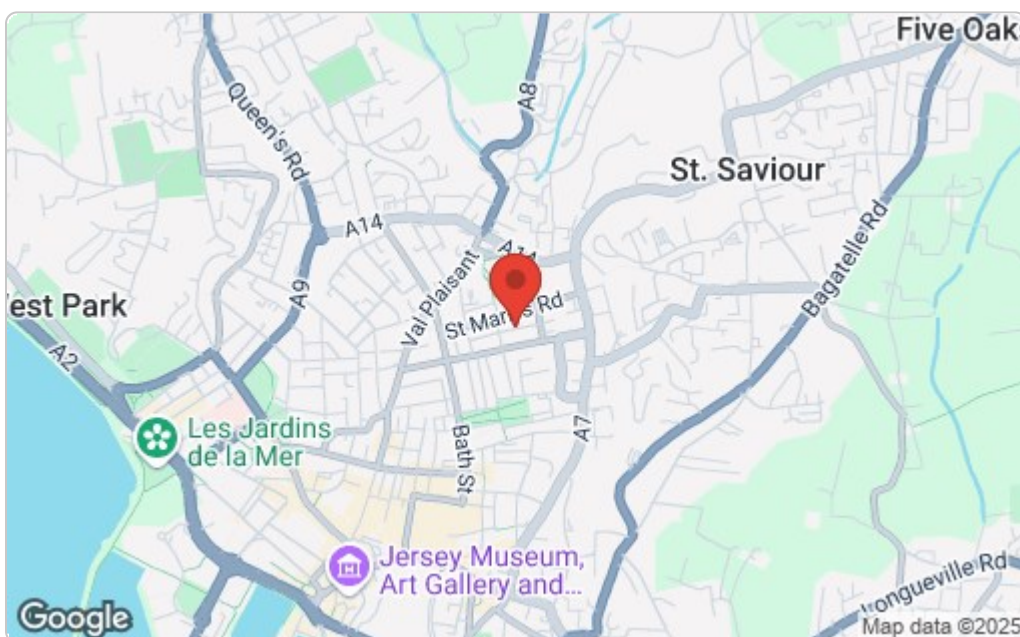

**Le Rossignol Estates**  
The Nightingales  
6 La Ville du Bocage  
St Peter, Jersey JE3 7AT

**01534 767 767**  
[sales@lerestates.com](mailto:sales@lerestates.com)  
[www.lerestates.com](http://www.lerestates.com)

These details are set out for guidance and do not constitute any part of an offer or contract. Applicants should not rely on them as statements or representations of fact or that the property or its services or any systems or equipment are in good and working condition. Any reference to alterations to, or use of, any part of the property is not a statement that any planning, building regulations or other consent has been obtained. No extras or contents mentioned in these particulars are necessarily included in the sale and are included for descriptive purposes only. Title, planning and survey matters must be verified by any applicant taking advice from their appropriate professional adviser. No person being a principal, employee or consultant of Le Rossignol Estates, has the authority to make or give any representation or warranty in respect of the property.